

Digital Imaging with *Krita* software

Lesson 9

(Text)

Open/Make an Image

Open a .kra file you have already made
or...

Quickly make a new one

Draw on or fill a layer

Use the Text tool

When you make text
it will automatically make its own layer
on top of your current layer
This new layer will be a “vector” layer

To use **Text...**

Choose the “T” tool icon (at top right of Tools column)



In the canvas, click and drag to make a rectangle

When you make the rectangle
a window opens to “Edit Text”

Define the text

The text:

Default text is “Placeholder Text”

Click and drag over that to select it
Type some new text

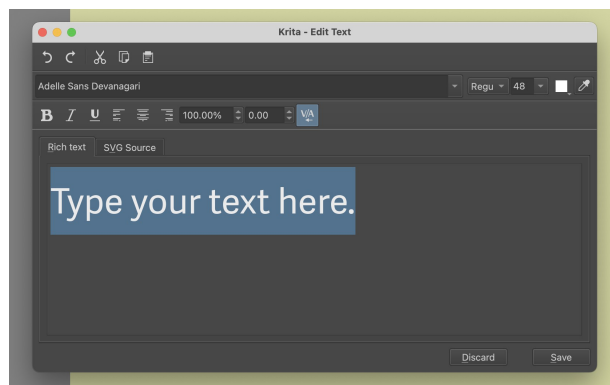

Color

The color is whatever is your current color
To change this, click the little color icon
at top right inside the *Edit Text* window

Size

Size is whatever last text size was
To change this, click arrow next to the number
just to left of the color box
Select or type a new size

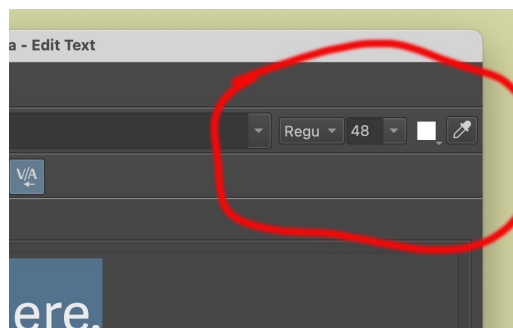

Digital Imaging with *Krita* software

Lesson 9

(Text)

Font

Font is the “style” of the text

The current font is the name you see at top-left of *Edit Text* window

Click the arrow next to that name

Drag to select a font

Click on “Save” to save all these changes

The changes don't appear on your canvas
until you hit the Save button

Re-edit the text

To re-edit some text you have already made...

Choose the “T” tool again

Double click inside the rectangle of the text

The Edit Text window opens again